

NO.	DATE	DESCRIPTION
3	2/17/17	UPDATED MAPPING
2	2/1/15	UPDATED MAPPING
1	2/1/14	UPDATED MAPPING

**STORMSEWER MAPS**  
**INDEX MAP**

**Gordon L. Brown & Associates, Inc.**  
Civil Engineers & Surveyors  
2238 South Queen Street  
York, Pa. 17402-4631  
**GLB&A** (717) 741-4621

**EAST MANCHESTER TOWNSHIP**  
York County, Pennsylvania

DRAWN BY	S.J.S.
CHECKED BY	B.W.T.
SCALE	1"=1500'
DATE	04/09/09
DWG. NO.	L-3232
FILE NO.	37.09.11712
SHEET	1 OF 1

FILED: 2009/04/09 10:00 AM York County Register of Deeds











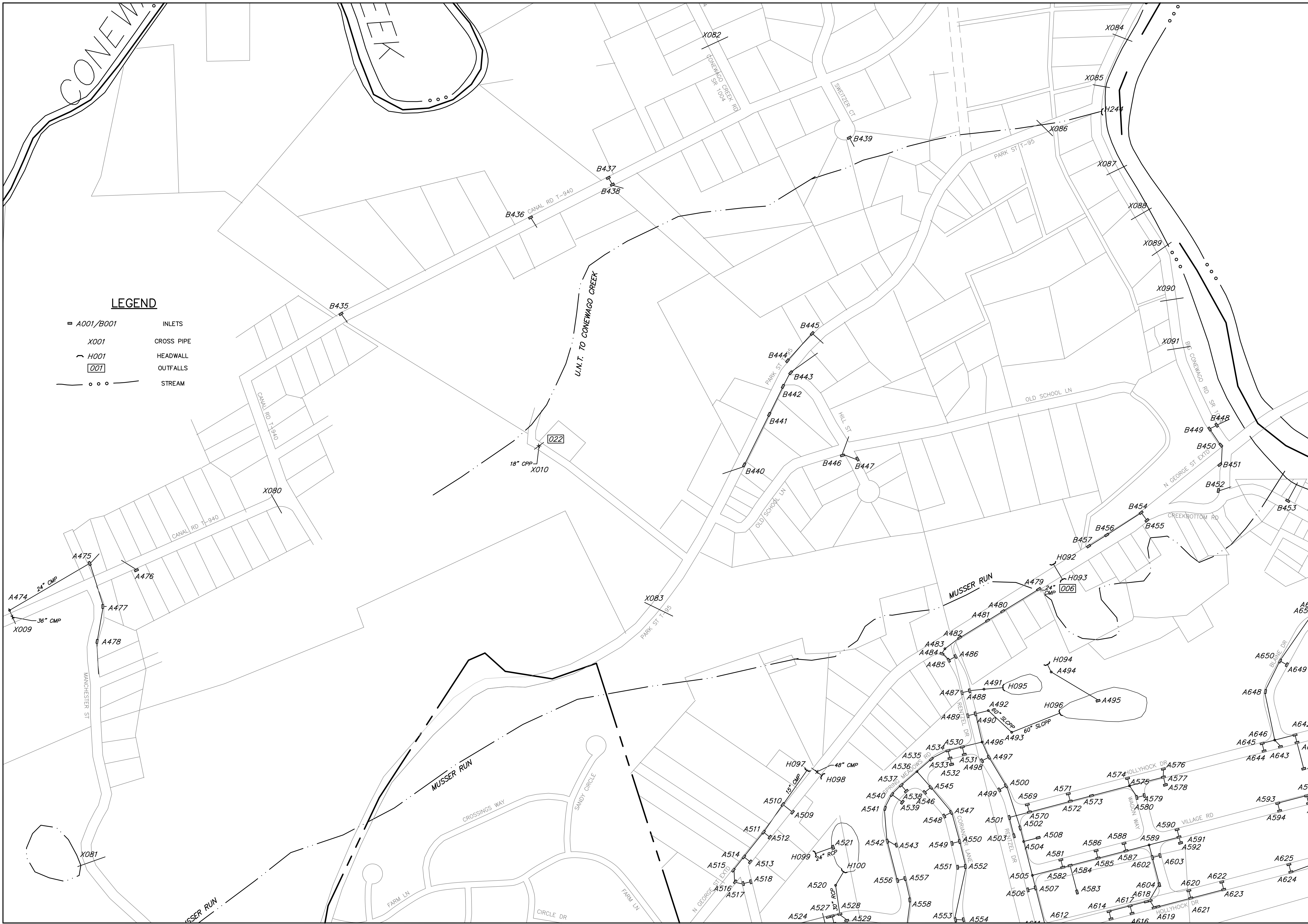

**LEGEND**

- ▣ A001/B001 INLETS
- X001 CROSS PIPE
- H001 HEADWALL
- 001 OUTFALLS
- STREAM

NO.	DATE	DESCRIPTION
2	2/17/17	UPDATED MAPPING
1	2/1/14	UPDATED MAPPING

**STORMSEWER MAPS**  
MAP-6

Gordon L. Brown & Associates, Inc.  
Civil Engineers & Surveyors  
2238 South Queen Street  
York, Pa. 17402-4631  
**GLB&A** (717) 741-4621

**EAST MANCHESTER TOWNSHIP**  
York County, Pennsylvania

DRAWN BY	S.J.S.
CHECKED BY	B.W.T.
SCALE	1"=200'
DATE	04/09/09
DWG. NO.	L-3232
FILE NO.	37.09.11712
SHEET	6 OF 30





FILED: 2009/04/09 10:00 AM York County, PA. 17402-4631





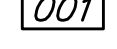

**LEGEND**

-  A001/B001 INLETS
-  X001 CROSS PIPE
-  H001 HEADWALL
-  O01 OUTFALLS
-  . . . . . STREAM



Township

NO.	DATE	DESCRIPTION
2	2/17/17	UPDATED MAPPING
1	2/1/14	UPDATED MAPPING

**STORMSEWER  
MAPS**

**MAP-9**

**Gordon L. Brown & Associates, Inc.**  
Civil Engineers & Surveyors

2238 South Queen Street  
York, Pa. 17402-4631  
**GLB&A** (717) 741-4621

**EAST MANCHESTER TOWNSHIP**

York County, Pennsylvania

DRAWN BY	S.J.S.
CHECKED BY	B.W.T.
SCALE	1"=200'
DATE	04/09/09
DWG. NO.	L-3232
FILE NO.	37.09.11712
SHEET	9 OF 30

P:\JOB\_2009\MapSheet\East Manchester\_Township\_PipeMap.dwg (2/17/17) S:\Users\jls\My Documents\MapSheet.dwg (2/17/17) S:\Users\jls\My Documents\MapSheet.dwg (2/17/17)



**LEGEND**

- A001/B001      INLETS
- X001          CROSS PIPE
- ~ H001          HEADWALL
- ▭ O01          OUTFALLS
- STREAM

NO.	DATE	DESCRIPTION
2	2/17/17	UPDATED MAPPING
1	2/1/14	UPDATED MAPPING

**STORMSEWER MAPS**  
MAP-10

**Gordon L. Brown & Associates, Inc.**  
Civil Engineers & Surveyors  
2238 South Queen Street  
York, Pa. 17402-4631  
**GLB&A** (717) 741-4621

**EAST MANCHESTER TOWNSHIP**  
York County, Pennsylvania

DRAWN BY	S.J.S.
CHECKED BY	B.W.T.
SCALE	1"=200'
DATE	04/09/09
DWG. NO.	L-3232
FILE NO.	37.09.11712
SHEET	10 OF 30

FILED: 2009/04/09 10:00 AM York County, PA 17402-4631

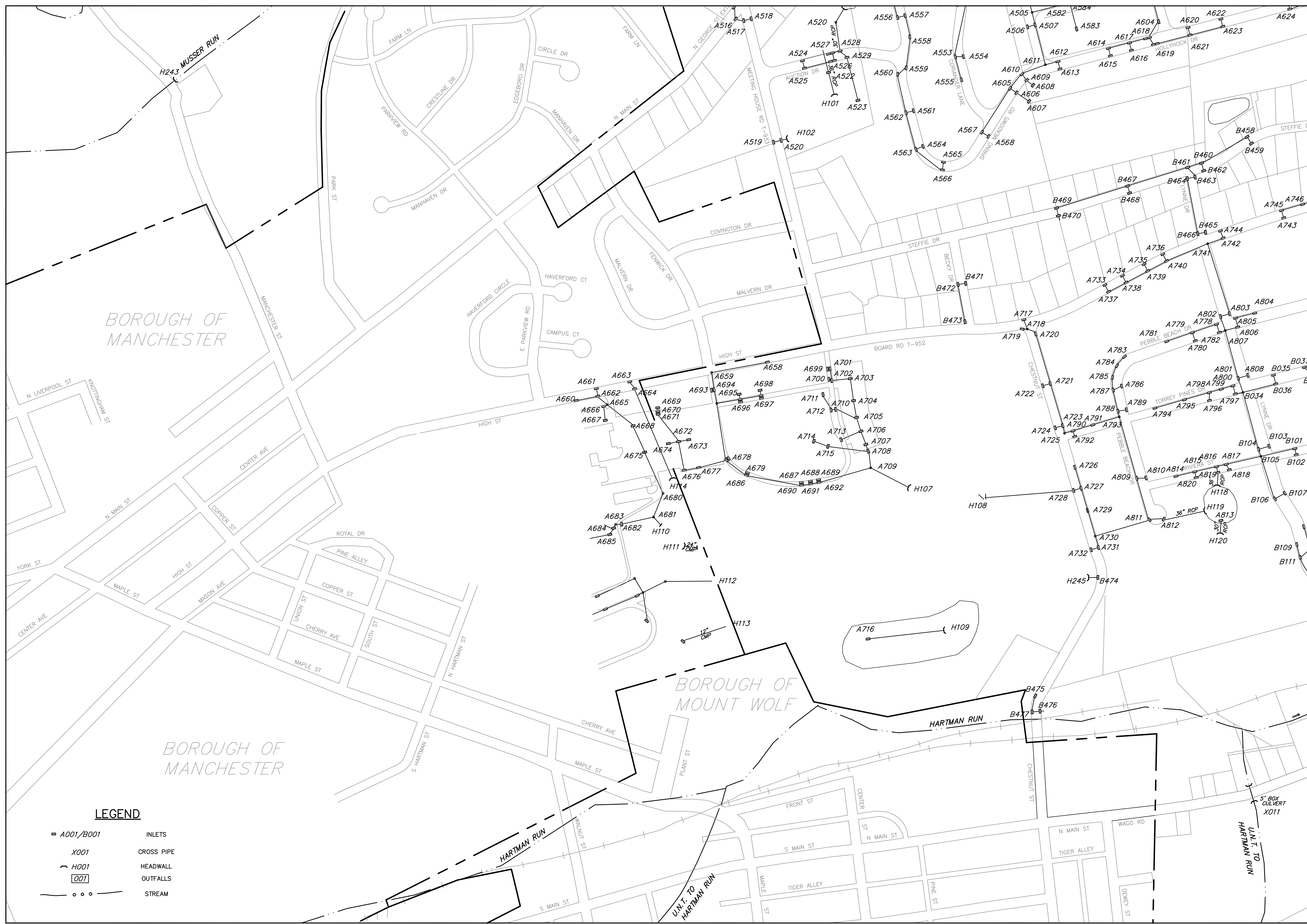

**LEGEND**

- ▣ A001/B001 INLETS
- X001 CROSS PIPE
- ⌒ H001 HEADWALL
- O01 OUTFALLS
- STREAM

NO.	DATE	DESCRIPTION
2	2/17/17	UPDATED MAPPING
1	2/1/14	UPDATED MAPPING

**STORMSEWER MAPS**  
MAP-11

Gordon L. Brown & Associates, Inc.  
Civil Engineers & Surveyors  
2238 South Queen Street  
York, Pa. 17402-4631  
**GLB&A** (717) 741-4621

**EAST MANCHESTER TOWNSHIP**  
York County, Pennsylvania

DRAWN BY	S.J.S.
CHECKED BY	B.W.T.
SCALE	1"=200'
DATE	04/09/09
DWG. NO.	L-3232
FILE NO.	37.09.11712
SHEET	11 OF 30

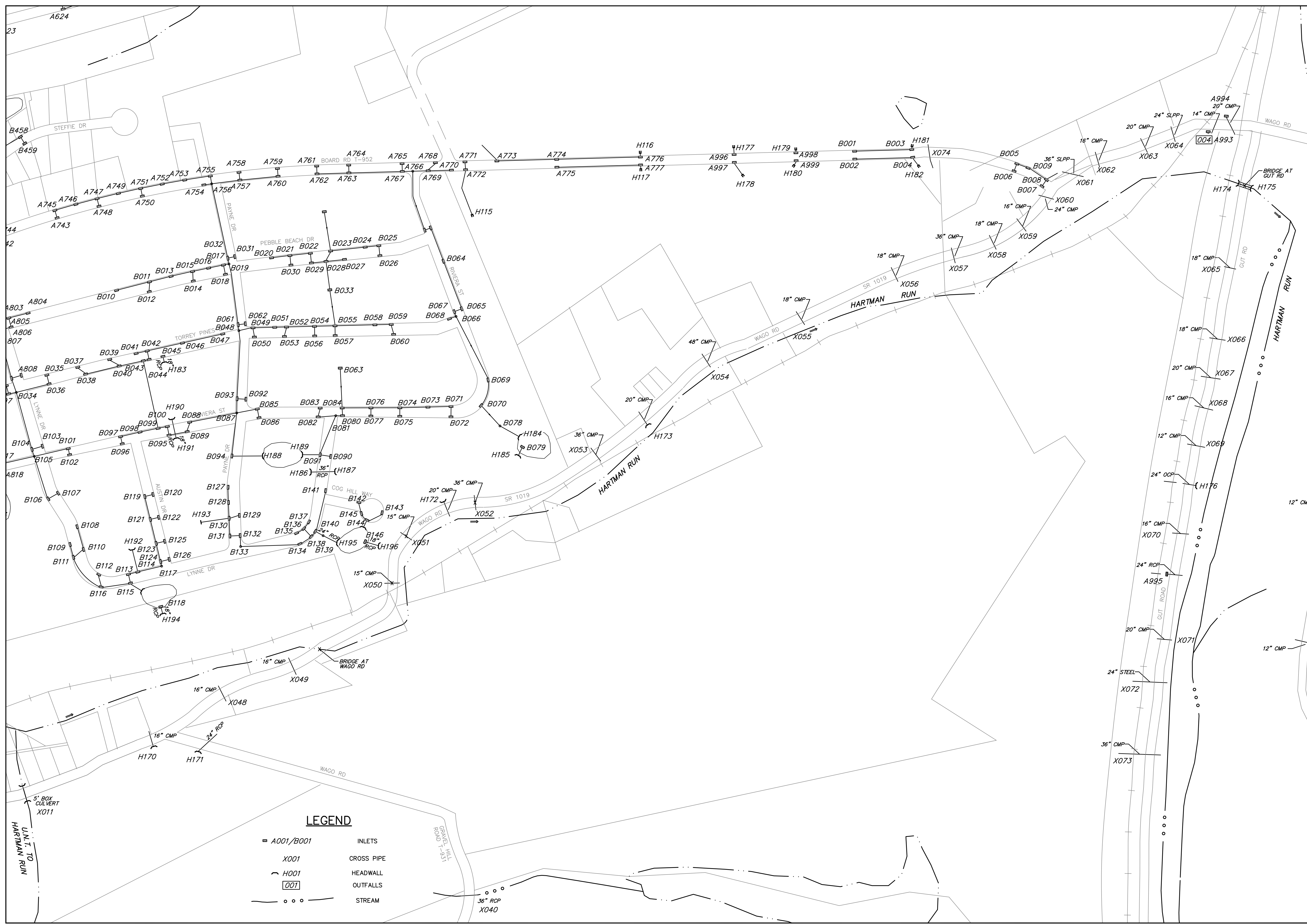

**LEGEND**

	A001/B001	INLETS
	X001	CROSS PIPE
	H001	HEADWALL
	O001	OUTFALLS
		STREAM

						UPDATED MAPPING	DESCRIPTION
						2/17/17	
						1/21/14	
						NO.	DATE

**STORMSEWER MAPS**

MAP-12

**Gordon L. Brown & Associates, Inc.**  
Civil Engineers & Surveyors

2238 South Queen Street  
York, Pa. 17402-4631  
**GLB&A** (717) 741-4621

**EAST MANCHESTER TOWNSHIP**

York County, Pennsylvania

DRAWN BY	S.J.S.
CHECKED BY	B.W.T.
SCALE	1"=200'
DATE	04/09/09
DWG. NO.	L-3232
FILE NO.	37.09.11712
SHEET	12 OF 30

P:\JOB\_2009\EastManchester\StormSewer\Map12.dwg, Map12.mxd, 04/09/09 11:25:24 AM



# Manchester

# TOWNSHIP

**LEGEND**

	INLETS
	CROSS PIPE
	HEADWALL
	OUTFALLS
	STREAM

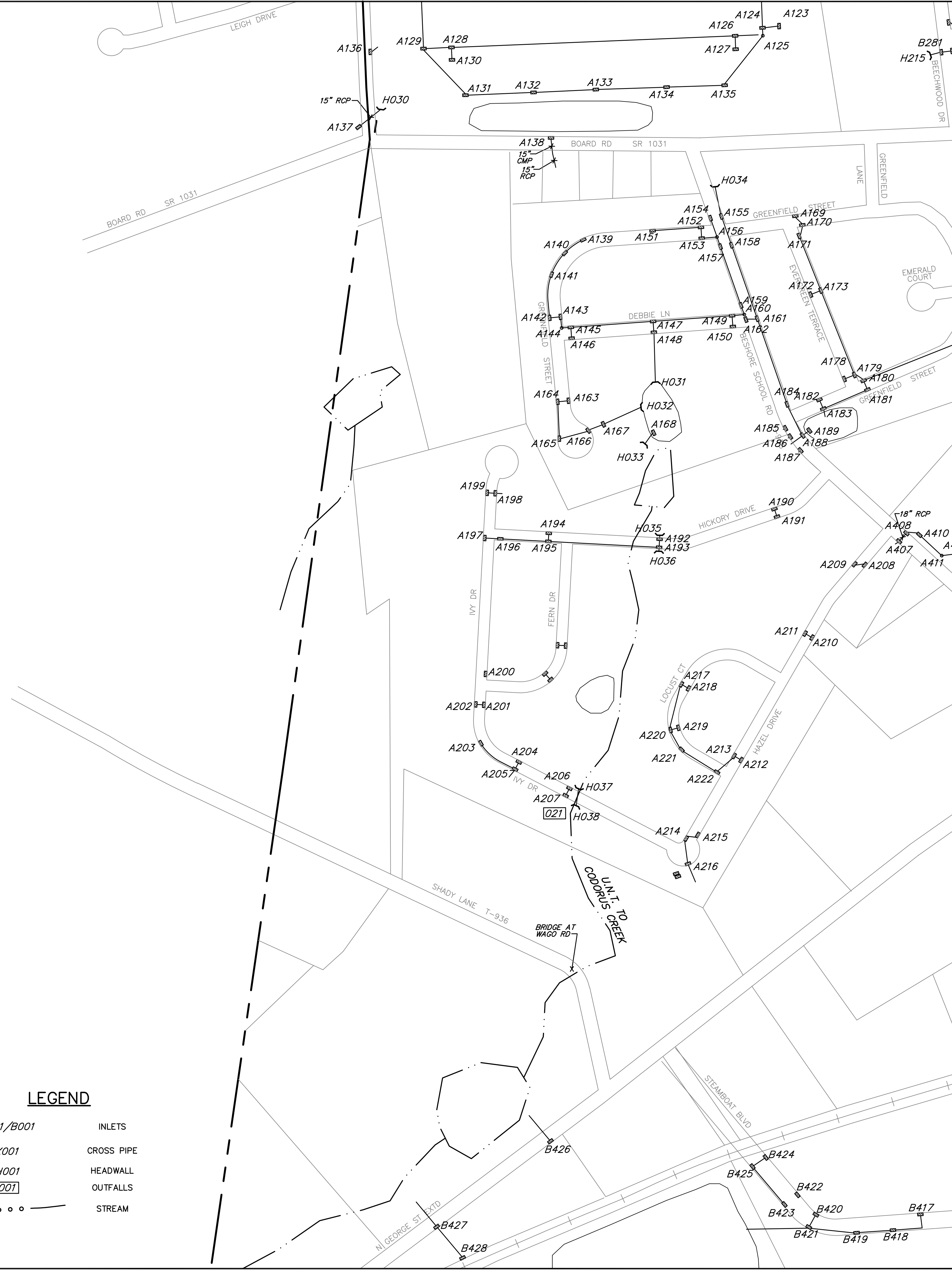

NO.	DATE	DESCRIPTION
2	2/17/17	UPDATED MAPPING
1	2/1/14	UPDATED MAPPING

**STORMSEWER MAPS**  
MAP-14

Gordon L. Brown & Associates, Inc.  
Civil Engineers & Surveyors  
2238 South Queen Street  
York, Pa. 17402-4631  
**GLB&A** (717) 741-4621

**EAST MANCHESTER TOWNSHIP**  
York County, Pennsylvania

DRAWN BY	S.J.S.
CHECKED BY	B.W.T.
SCALE	1"=200'
DATE	04/09/09
DWG. NO.	L-3232
FILE NO.	37.09.11712
SHEET	14 OF 30

FILED: 2009/04/09 10:00 AM York County, PA. 37.09.11712

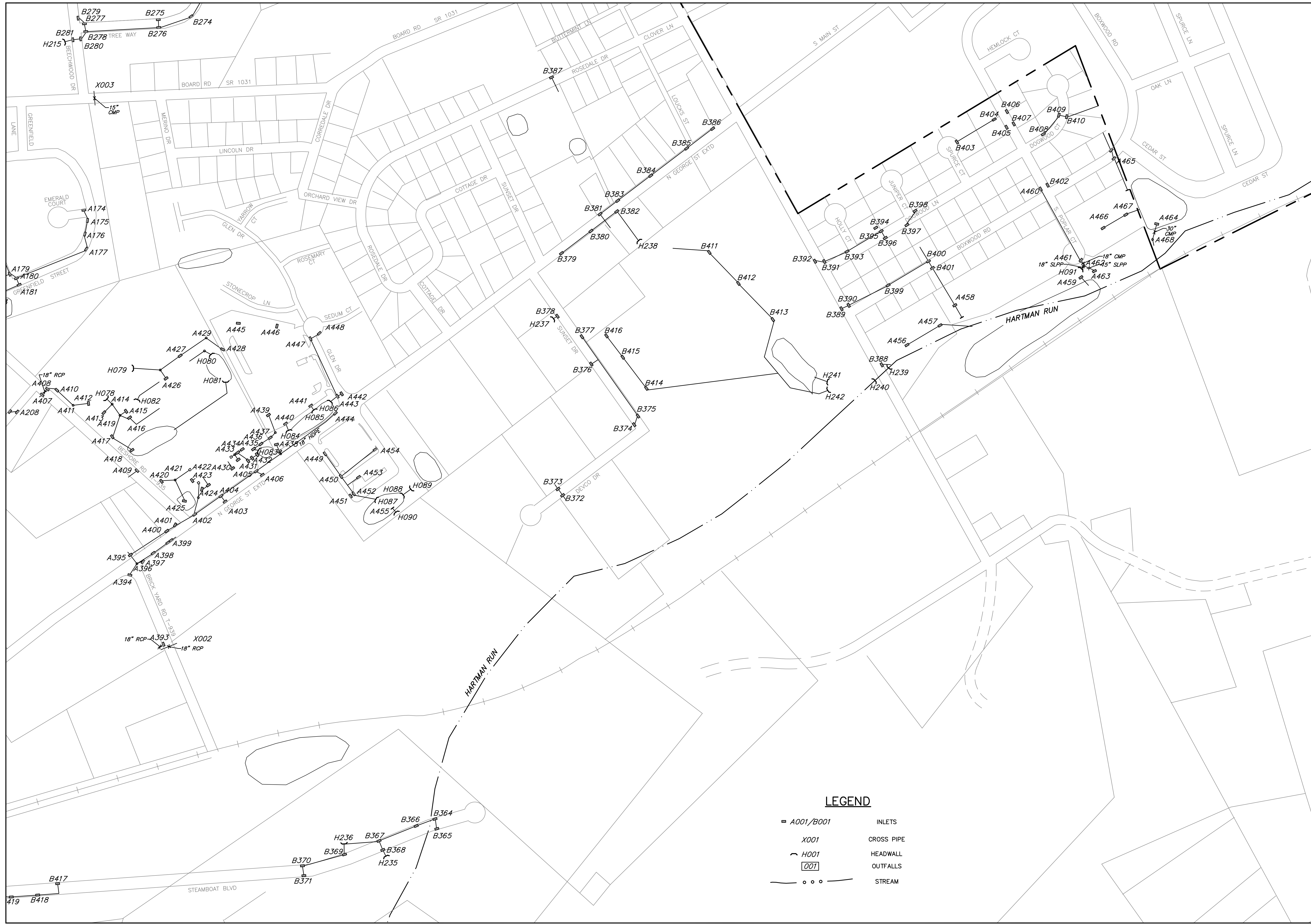

**LEGEND**

- A001/B001 INLETS
- X001 CROSS PIPE
- H001 HEADWALL
- 001 OUTFALLS
- ○ ○ ○ — STREAM

NO.	DATE	DESCRIPTION
2	2/17/17	UPDATED MAPPING
1	2/1/14	UPDATED MAPPING

**STORMSEWER MAPS**  
MAP-15

Gordon L. Brown & Associates, Inc.  
Civil Engineers & Surveyors  
2238 South Queen Street  
York, Pa. 17402-4631  
**GLB&A** (717) 741-4621

**EAST MANCHESTER TOWNSHIP**  
York County, Pennsylvania

DRAWN BY	S.J.S.
CHECKED BY	B.W.T.
SCALE	1"=200'
DATE	04/09/09
DWG. NO.	L-3232
FILE NO.	37.09.11712
SHEET	15 OF 30

FILED: 2009/04/09 10:00 AM York County, PA 17402-4631





**LEGEND**

- ▣ A001/B001      INLETS
- X001              CROSS PIPE
- ~ H001            HEADWALL
- 001             OUTFALLS
- ○ ○ ○ —      STREAM



NO.	DATE	DESCRIPTION
2	2/17/17	UPDATED MAPPING
1	2/1/14	UPDATED MAPPING

**STORMSEWER  
MAPS**

MAP-17

**Gordon L. Brown & Associates, Inc.**  
Civil Engineers & Surveyors

2238 South Queen Street  
York, Pa. 17402-4631  
**GLB&A** (717) 741-4621

**EAST MANCHESTER TOWNSHIP**  
York County, Pennsylvania

DRAWN BY S.J.S.  
CHECKED BY B.W.T.  
SCALE 1"=200'  
DATE 04/09/09  
DWG. NO. L-3232  
FILE NO. 37.09.11712  
SHEET 17 OF 30

FILED: 2009/04/09 10:00 AM York County, PA. Recorder: [Name] [Address] [Phone] [Fax] [Email]

# Man

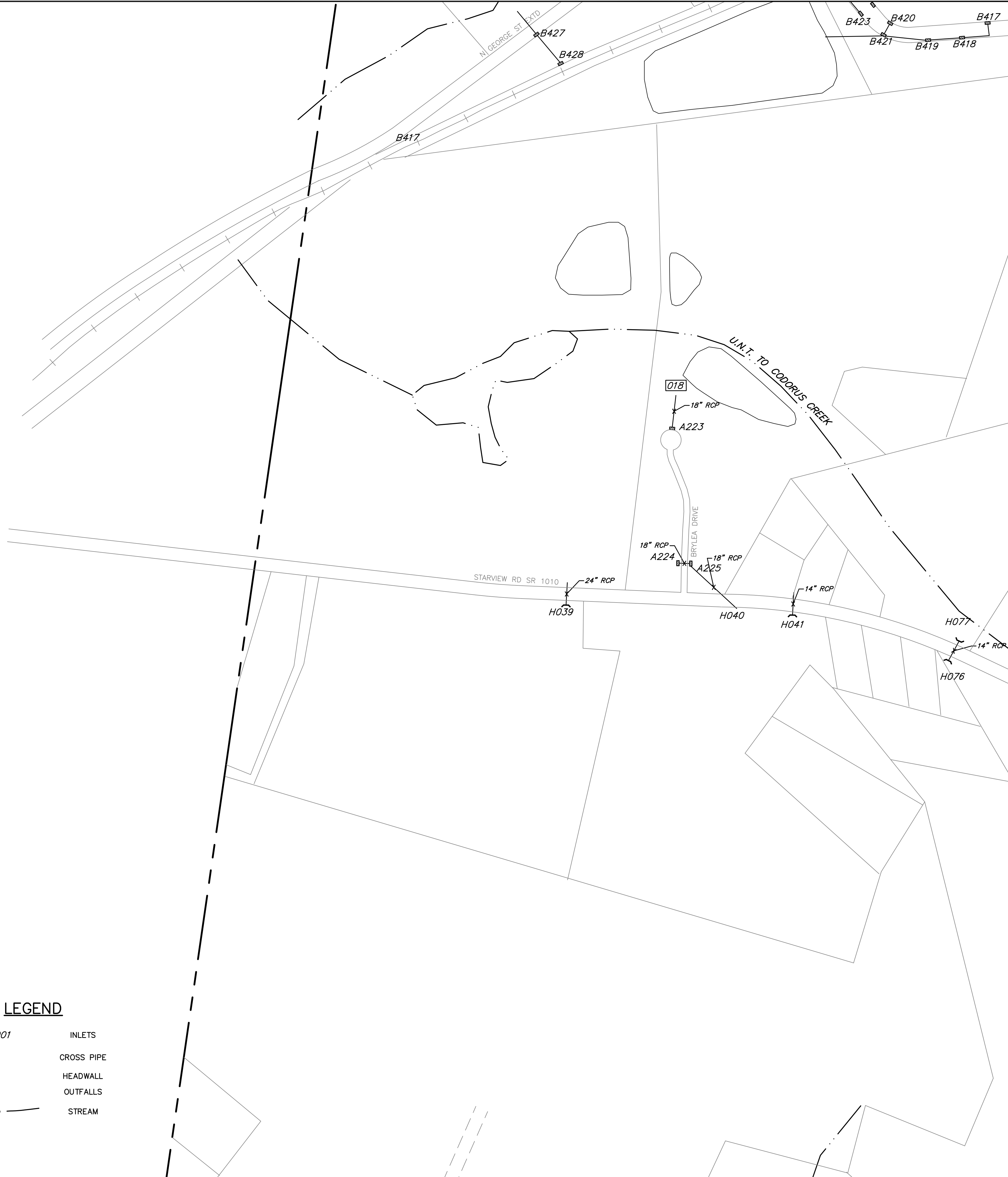

**LEGEND**

▣ A001/B001	INLETS
X001	CROSS PIPE
~ H001	HEADWALL
◻ 001	OUTFALLS
— ○ ○ ○ —	STREAM

NO.	DATE	DESCRIPTION
2	2/17/17	UPDATED MAPPING
1	2/1/14	UPDATED MAPPING

**STORMSEWER  
MAPS**

MAP-18

Gordon L. Brown & Associates, Inc.  
Civil Engineers & Surveyors

2238 South Queen Street  
York, Pa. 17402-4631

**GLB&A** (717) 741-4621

**EAST MANCHESTER TOWNSHIP**

York County, Pennsylvania

DRAWN BY	S.J.S.
CHECKED BY	B.W.T.
SCALE	1"=200'
DATE	04/09/09
DWG. NO.	L-3232
FILE NO.	37.09.11712
SHEET	18 OF 30

FILED: 2009/04/09 10:00 AM York County, PA 17402-4631



**LEGEND**

- ▣ A001/B001      INLETS
- X001            CROSS PIPE
- ┌ H001          HEADWALL
- 001            OUTFALLS
- ○ ○ ○ —      STREAM

NO.	DATE	DESCRIPTION
2	2/17/17	UPDATED MAPPING
1	2/1/14	UPDATED MAPPING

**STORMSEWER  
MAPS**

MAP-19

Gordon L. Brown & Associates, Inc.  
Civil Engineers & Surveyors

2238 South Queen Street  
York, Pa. 17402-4631  
**GLB&A** (717) 741-4621

**EAST MANCHESTER TOWNSHIP**

York County, Pennsylvania

DRAWN BY	S.J.S.
CHECKED BY	B.W.T.
SCALE	1"=200'
DATE	04/09/09
DWG. NO.	L-3232
FILE NO.	37.09.11712
SHEET	19 OF 30

F:\JOB\_2009\EastManchester\Map\Map 19 of 30.dwg, 04/09/09 10:23:11 AM

**LEGEND**

- ▣ A001/B001      INLETS
- X001              CROSS PIPE
- H001            HEADWALL
- 001             OUTFALLS
- ○ ○ ○ —      STREAM



NO.	DATE	DESCRIPTION
2	2/17/17	UPDATED MAPPING
1	2/1/14	UPDATED MAPPING

**STORMSEWER MAPS**  
MAP-20

Gordon L. Brown & Associates, Inc.  
Civil Engineers & Surveyors  
2238 South Queen Street  
York, Pa. 17402-4631  
**GLB&A** (717) 741-4621

**EAST MANCHESTER TOWNSHIP**  
York County, Pennsylvania

DRAWN BY	S.J.S.
CHECKED BY	B.W.T.
SCALE	1"=200'
DATE	04/09/09
DWG. NO.	L-3232
FILE NO.	37.09.11712
SHEET	20 OF 30

FILED: 2009/04/09 09:00 AM York County, PA 17402-4631

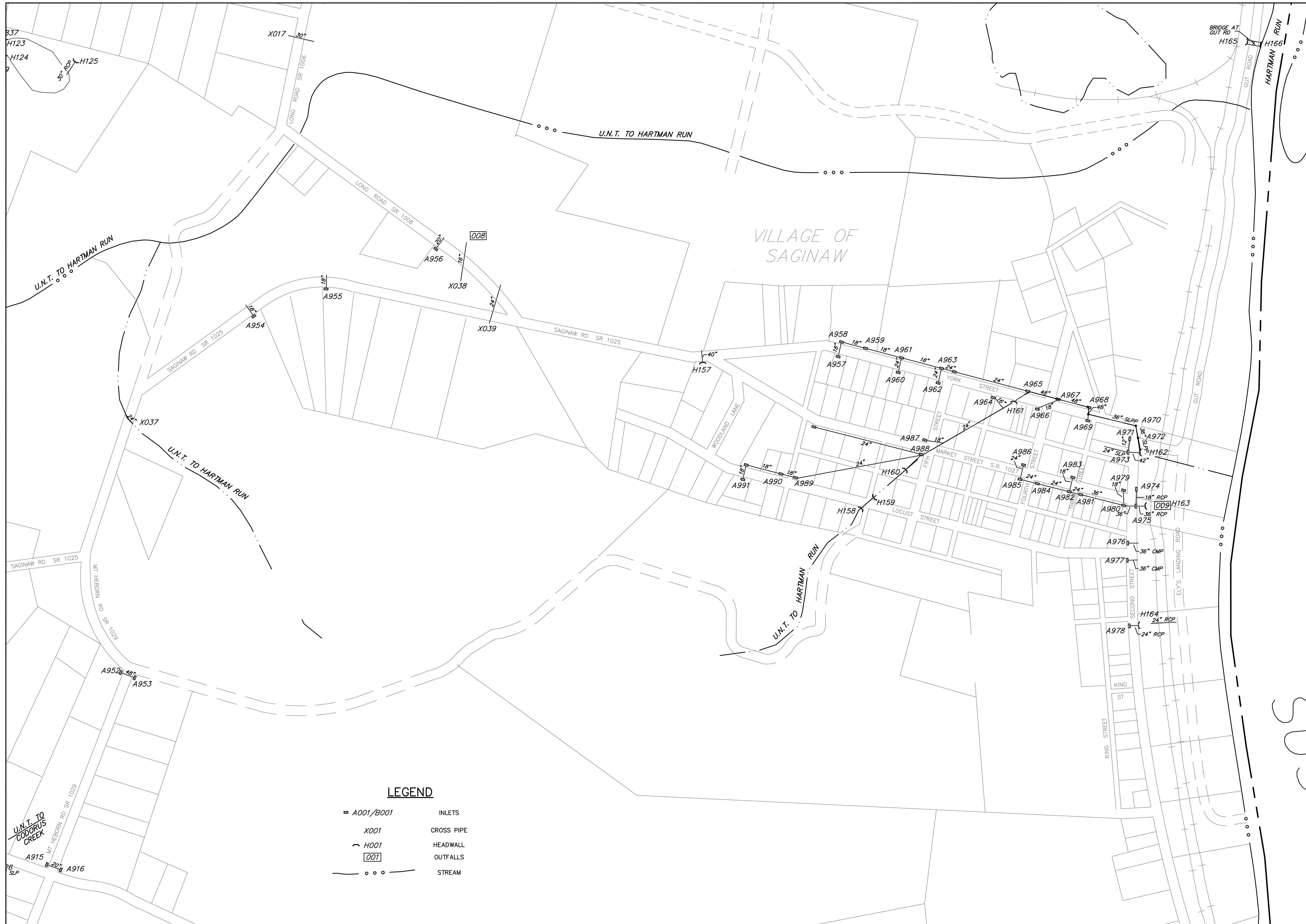

**LEGEND**

- ▣ A001/B001      INLETS
- X001              CROSS PIPE
- H001             HEADWALL
- ▣001              OUTFALLS
- ○ ○ ○ —      STREAM

NO.	DATE	DESCRIPTION
2	2/17/17	UPDATED MAPPING
1	2/1/14	UPDATED MAPPING

**STORMSEWER MAPS**  
MAP-21

**Gordon L. Brown & Associates, Inc.**  
Civil Engineers & Surveyors  
2238 South Queen Street  
York, Pa. 17402-4631  
**GLB&A** (717) 741-4621

**EAST MANCHESTER TOWNSHIP**  
York County, Pennsylvania

DRAWN BY	S.J.S.
CHECKED BY	B.W.T.
SCALE	1"=200'
DATE	04/09/09
DWG. NO.	L-3232
FILE NO.	37.09.11712
SHEET	21 OF 30

*GLB&A*

FILED: 2009/04/09 10:00 AM York County, PA 17402-4631

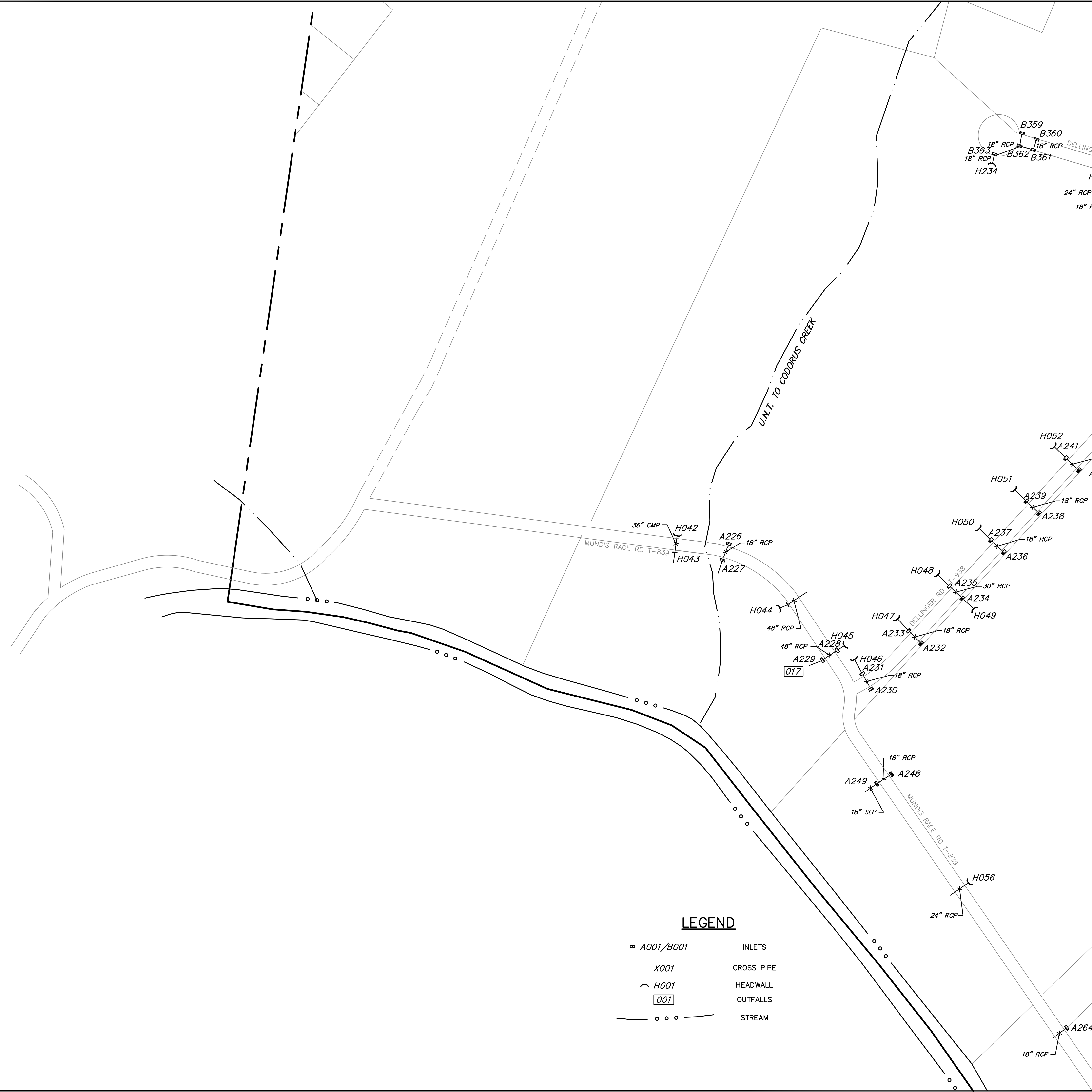

**LEGEND**

- A001/B001 INLETS
- X001 CROSS PIPE
- ~ H001 HEADWALL
- 001 OUTFALLS
- ○ ○ ○ — STREAM

NO.	DATE	DESCRIPTION
2	2/17/17	UPDATED MAPPING
1	2/1/14	UPDATED MAPPING

**STORMSEWER  
MAPS**

MAP-22

**Gordon L. Brown & Associates, Inc.**  
Civil Engineers & Surveyors

2238 South Queen Street  
York, Pa. 17402-4631  
**GLB&A** (717) 741-4621

**EAST MANCHESTER TOWNSHIP**

York County, Pennsylvania

DRAWN BY	S.J.S.
CHECKED BY	B.W.T.
SCALE	1"=200'
DATE	04/09/09
DWG. NO.	L-3232
FILE NO.	37.09.11712
SHEET	22 OF 30

F:\JOB\_2009\EastManchester\EastManchester\_Pipe\GIS\Manchester\_Pipe\DWG\DWG1 - Sewer Map 2016 (MPL) Job Map22 - 04/09/09 - 4.14.15 PM







**LEGEND**

- ▣ A001/B001      INLETS
- X001            CROSS PIPE
- ~ H001          HEADWALL
- 001          OUTFALLS
- · · · —        STREAM

NO.	DATE	DESCRIPTION
2	2/17/17	UPDATED MAPPING
1	2/1/14	UPDATED MAPPING

**STORMSEWER MAPS**  
MAP-24

Gordon L. Brown & Associates, Inc.  
Civil Engineers & Surveyors  
2238 South Queen Street  
York, Pa. 17402-4631  
**GLB&A** (717) 741-4621

**EAST MANCHESTER TOWNSHIP**  
York County, Pennsylvania

DRAWN BY      S.J.S.  
CHECKED BY    B.W.T.  
SCALE          1"=200'  
DATE            04/09/09  
DWG. NO.       L-3232  
FILE NO.        37.09.11712  
SHEET          24 OF 30

PLD\_20091014EastManchester\_Township\_PipeSewerMap.dwg - Sheet 24 of 30 - 4/9/09 4:43:03 PM





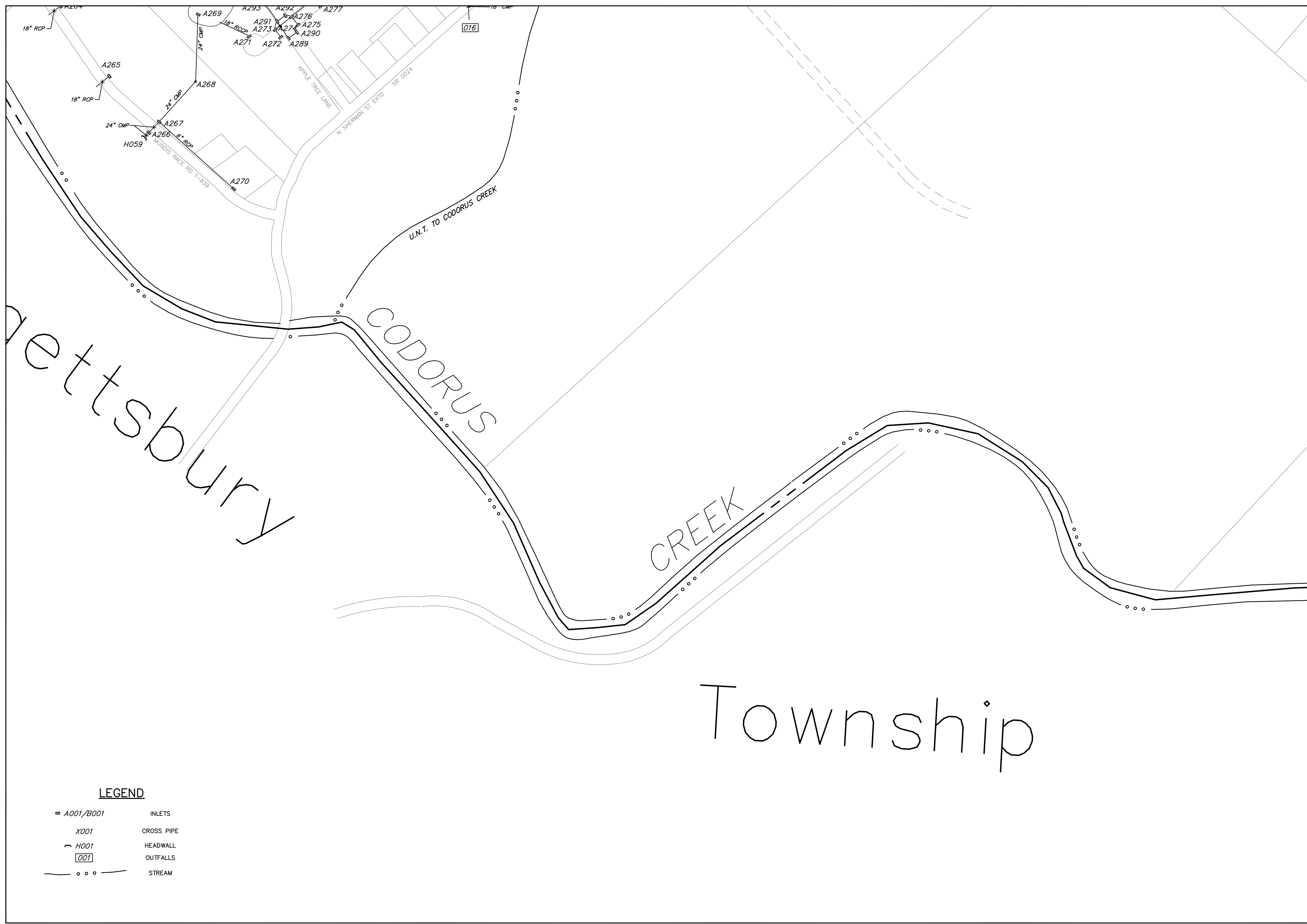

**LEGEND**

- A001/B001 INLETS
- X001 CROSS PIPE
- H001 HEADWALL
- 001 OUTFALLS
- ○ ○ ○ — STREAM

<p><b>STORMSEWER MAPS</b></p> <p>MAP-27</p>		<p>2 2/17/17</p>		<p>UPDATED MAPPING</p>
		<p>1 2/1/14</p>		<p>UPDATED MAPPING</p>
<p><b>STORMSEWER MAPS</b></p>		<p>NO.</p>	<p>DATE</p>	<p>DESCRIPTION</p>
<p><b>Gordon L. Brown &amp; Associates, Inc.</b> Civil Engineers &amp; Surveyors 2238 South Queen Street York, Pa. 17402-4631 <b>GLB&amp;A</b> (717) 741-4621</p>				
<p><b>EAST MANCHESTER TOWNSHIP</b></p>				
<p>York County, Pennsylvania</p>				
<p>DRAWN BY S.J.S.</p>		<p>CHECKED BY B.W.T.</p>		
<p>SCALE 1"=200'</p>		<p>DATE 04/09/09</p>		
<p>DWG. NO. L-3232</p>		<p>FILE NO. 37.09.11712</p>		
<p>SHEET 27 OF 30</p>		<p></p>		

F:\JOB\_2009\Manchester\East Manchester\_Township\_Pipe\GIS\Manchester\_Pipe\Map27.mxd 2/17/17 4:25:08 PM



Hellam

CODORUS CREEK

Township

U.N.T. TO CODORUS CREEK

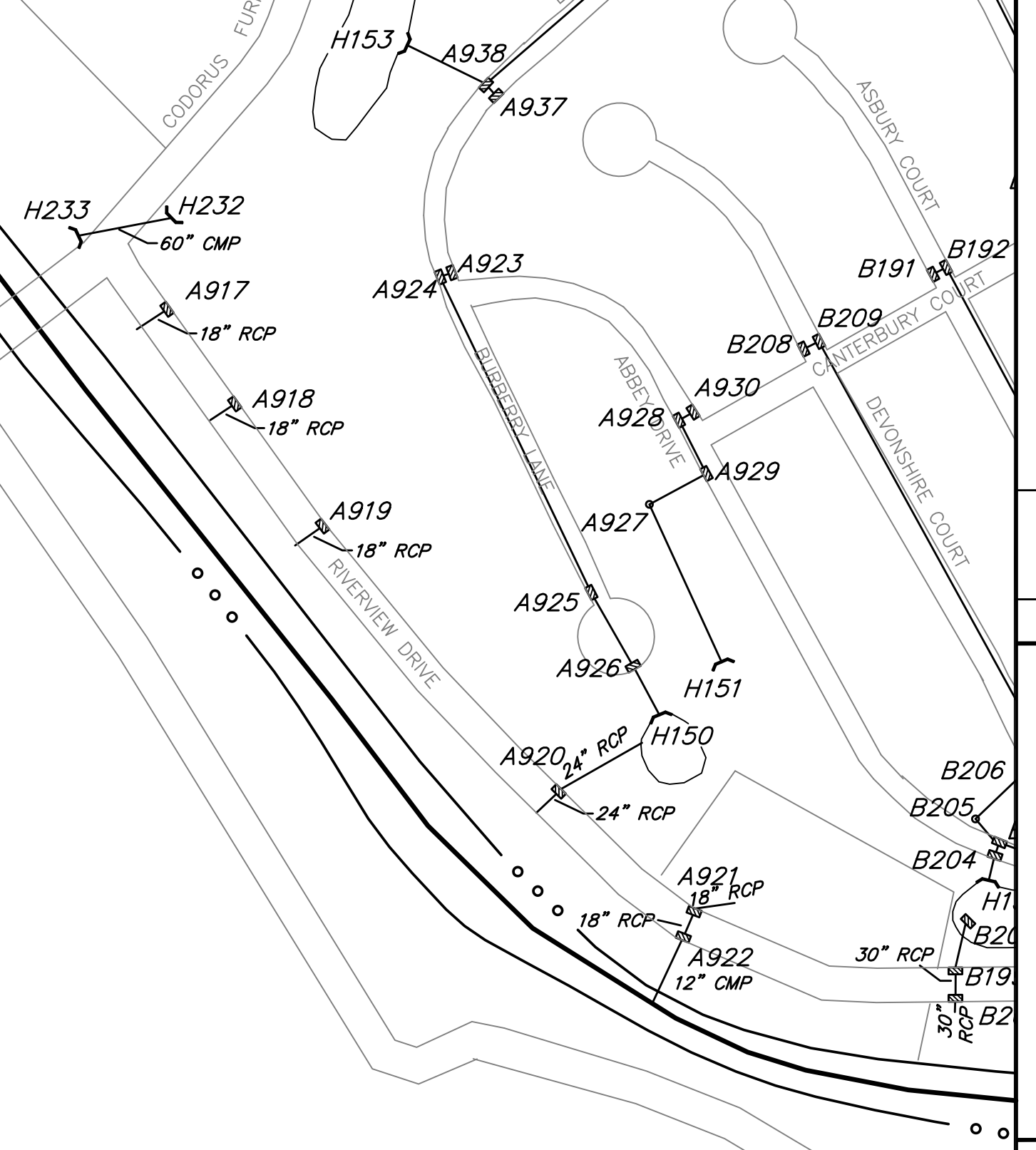

**LEGEND**

	A001/B001	INLETS
	X001	CROSS PIPE
	H001	HEADWALL
	001	OUTFALLS
		STREAM

NO.	DATE	DESCRIPTION
2	2/17/17	UPDATED MAPPING
1	2/1/14	UPDATED MAPPING

**STORMSEWER MAPS**

MAP-29

Gordon L. Brown & Associates, Inc.  
Civil Engineers & Surveyors

2238 South Queen Street  
York, Pa. 17402-4631

**GLB&A** (717) 741-4621

**EAST MANCHESTER TOWNSHIP**

York County, Pennsylvania

DRAWN BY	S.J.S.
CHECKED BY	B.W.T.
SCALE	1"=200'
DATE	04/09/09
DWG. NO.	L-3232
FILE NO.	37.09.11712
SHEET	29 OF 30

F:\JOB\_2009\Hellam\East Manchester\_Township\_Pipe\DWG\Storm Sewer Map 29.dwg, Map29, 04/09/09 4:52:27 PM

